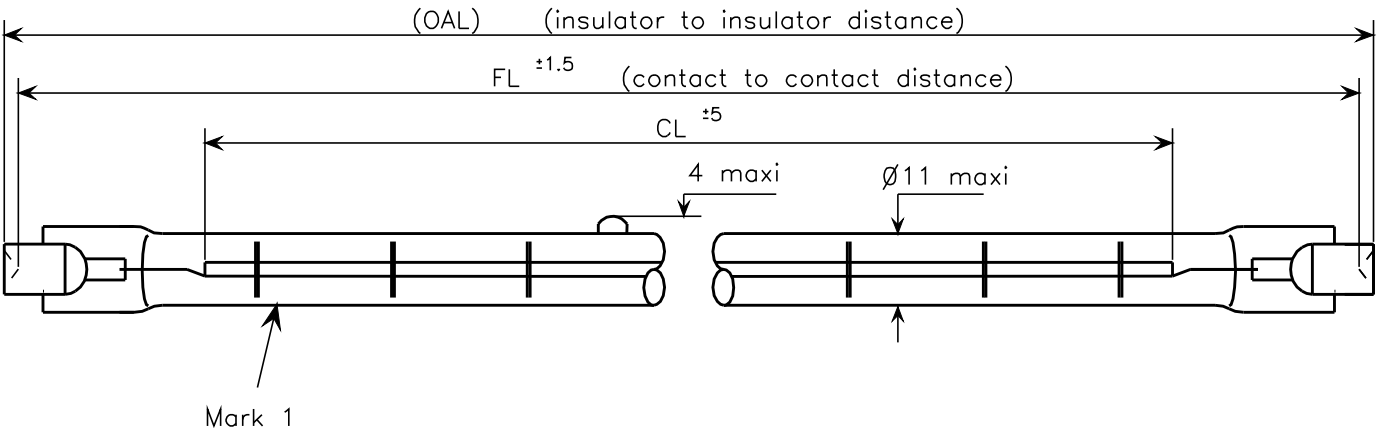

Fig. 1: Structure



OAL	221	FL	218
CL	165		
Mark 1	DIRTECH + lot DS235V500W165RsH		

Specifications:

- Nominal voltage: 235 V
- Wattage: 500 W  $\pm$  5%
- Average life: 5000 Hrs (with AC power supply, 50 or 60 Hz ,  
continuously at room temperature and free from vibration)
- Lighting position : Horizontal  $\pm$  4%
- Tc : 2450 K
- Strength test:
- Base shall withstand tensile load of 1 Kgf
  - No damage should happen when compressive force of 5 Kgf is applied to both terminal  
(as breakage of the tube, drop of the base...)

Tube: Clear

Filament with sub-coil

Fig. 2: Base part details

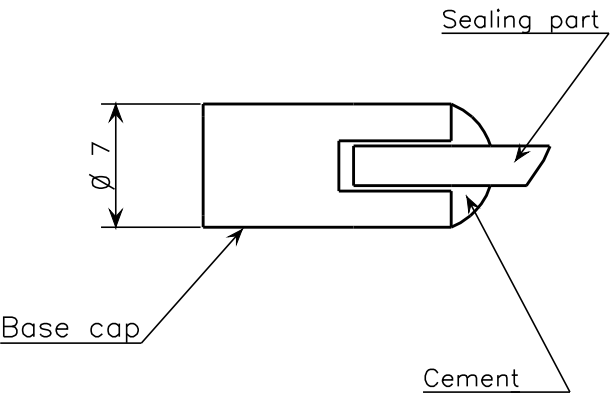
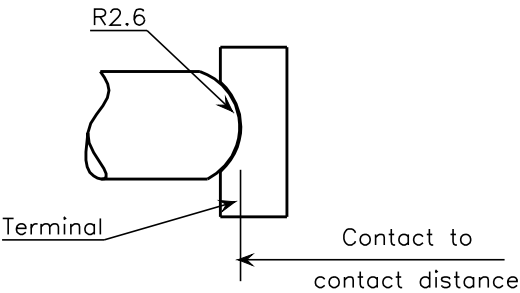

Fig. 3: Definition of contact to  
contact distance



It shall be distance between both top of  
ends at rod when concave of terminal is  
pushed by rod with R 2.6

Type: InfraRed Halogen Heater Lamp DS 235V 500W 165 RsH		Modif.:	
		Date:	
Date: 14-10-14	DIRTECH	Version IC-328	Comments