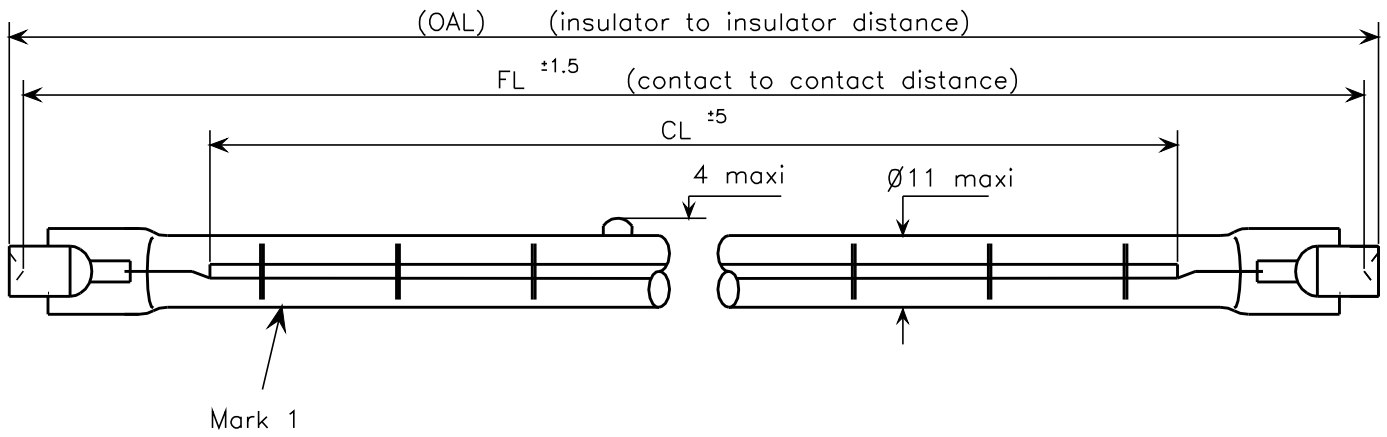

Fig. 1: Structure



OAL	447.9	FL	445.5
CL	385		
Mark 1	DIRTECH + lot DS230V1530W385RSH		

Specifications:

Tube: Clear

Nominal voltage: 230 V

Wattage: 1530 W ± 5%

Average life: 2000 Hrs (with AC power supply, 50 or 60 Hz ,
continuously at room temperature and free from vibration)

Lighting position : Horizontal ± 4%

Tc : 2400 K

Strength test:

- Base shall withstand tensile load of 1 Kgf
- No damage should happen when compressive force of 5 Kgf is applied to both terminal
(as breakage of the tube, drop of the base...)

Fig. 2: Base part details

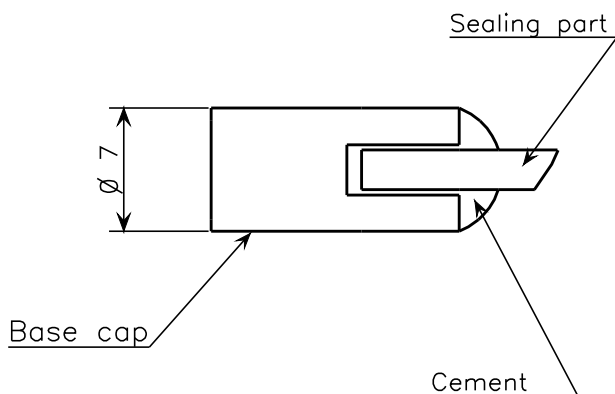
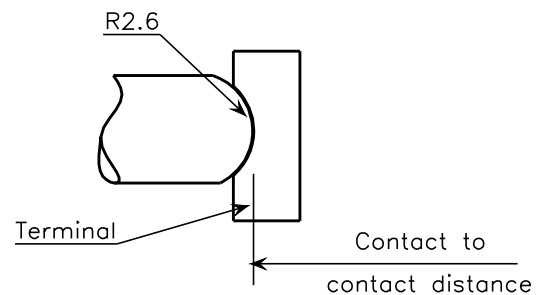

Fig. 3: Definition of contact to contact distance



It shall be distance between both top of ends at rod when concave of terminal is pushed by rod with R 2.6

Type: InfraRed Halogen Heater Lamp DS 230V 1530W 385 RSH		Modif.:	
		Date:	
Date: 14-10-14	DIRTECH	Version IC-330	Comments